



# HONDA INSTALLATION INSTRUCTIONS

Accessory  
**BICYCLE  
ATTACHMENT**  
P/N 08L07-E09-100

Application  
**2013 ODYSSEY**

Publications No.  
**All 13265**

Issue Date  
**AUG 2012**

Put this information in the glove box with the vehicle owner's manual.

## PARTS LIST

Bicycle attachment

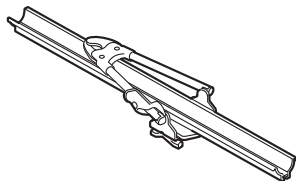

Hex wrench

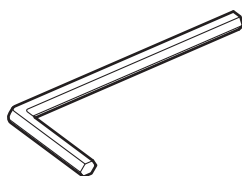

2 Keys



2 Wheel straps

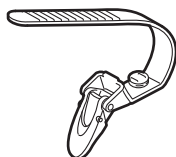

2 Tire adapters



2 End caps

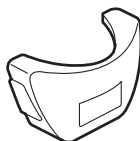

4 Bolts



4 Washers



2 Brackets

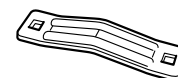

4 Knobs



Rear plate

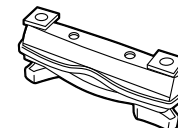

## TOOLS AND SUPPLIES REQUIRED

Tape measure

## Illustration of the Bicycle Attachment on the Vehicle

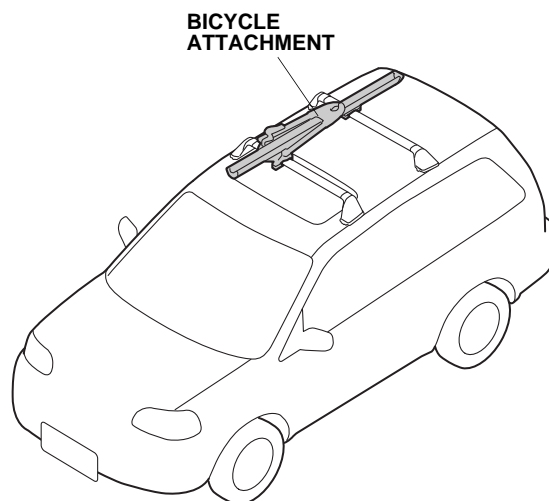

## INSTALLATION

### NOTE:

- This bicycle attachment is designed to be used exclusively with the Honda crossbars, which are sold separately.
- Do not use non-Honda accessories, carriers or attachments with this bicycle attachment kit.
- Install the bicycle attachment after installing the cross bars on the roof rails.
- Do not damage the roof and other finished surfaces of the body when installing this bicycle attachment.
- If you are installing more than one bicycle attachment, you may need to alternate the mounting positions (front to rear) to allow for handle bar clearance and key lock access.
- Make sure the tire adapters and the locking clamp lever are installed on the outboard side.

### Installing the Bicycle Attachment

This bicycle attachment kit is intended for installation on the passenger's side. If you are installing the bicycle attachment on the driver's side of the vehicle, continue with steps 1 and 2. If not, go to step 3.

1. Loosen the three socket bolts on the bottom of the front plate with the hex wrench included with the kit. Slide the front plate forward as shown.

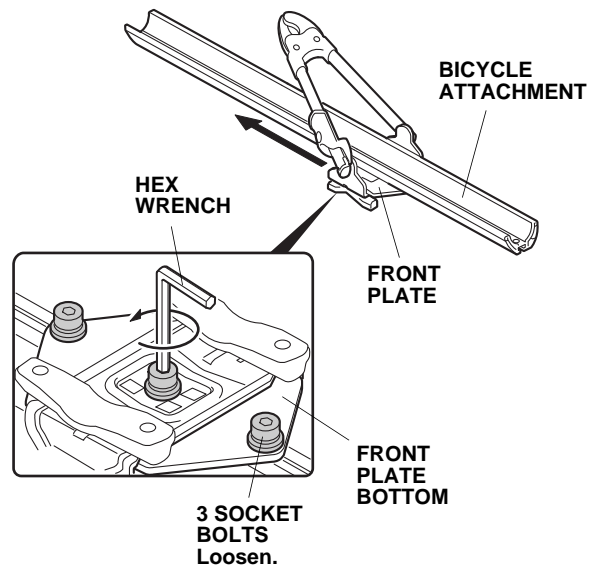

2. Set the front plate 245 mm (9.6 in.) from the end of the bicycle attachment, and retighten the three socket bolts on the bottom. Torque the three socket bolts to 8 N·m (5.9 lbf·ft). Rotate the arm as shown.

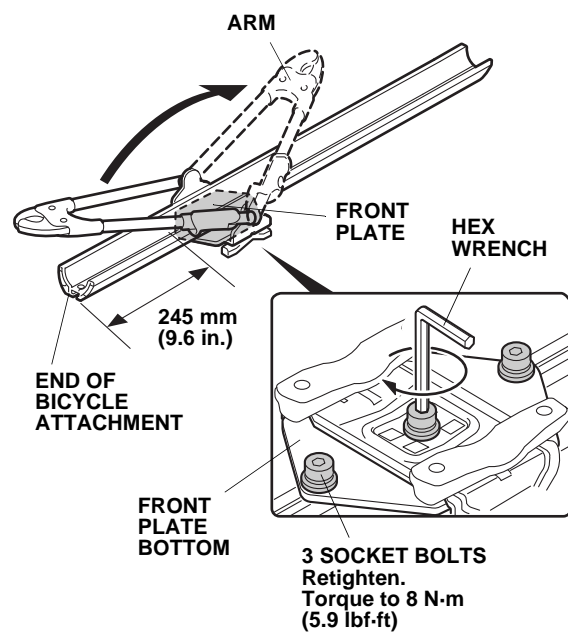

3. Remove the two thumbwheel screws, washers, and bracket from the rear plate. Slide the rear plate onto the bicycle attachment.

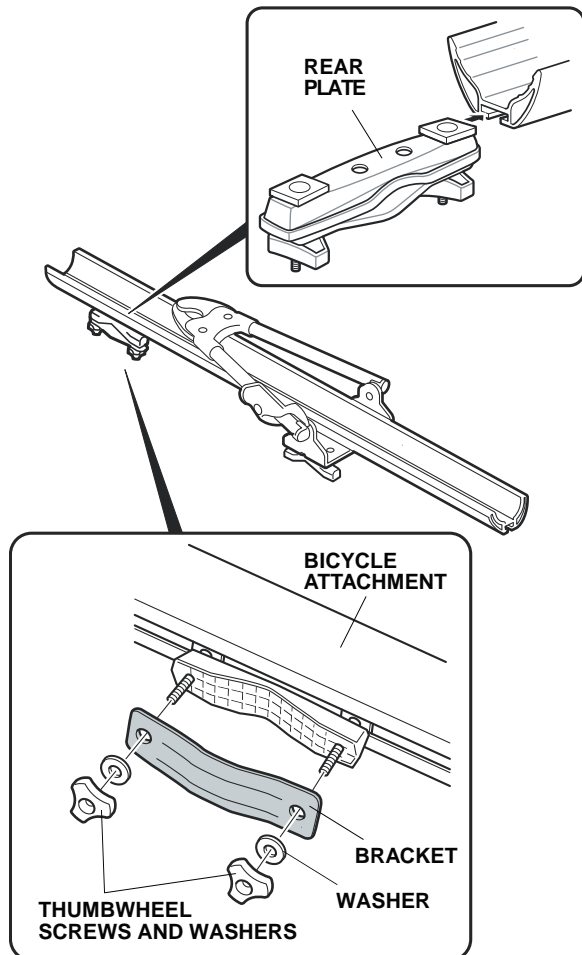

4. Insert the wheel strap into the tire adapter. Slide the wheel strap onto the end of the bicycle attachment. Install the other wheel strap on the other end of the attachment in the same way. Make sure that both wheel straps are facing the same way.

**For Installation on the Passenger's Side:**

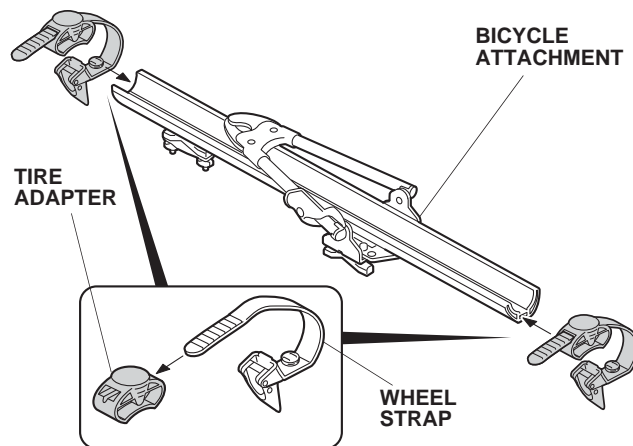

**For Installation on the Driver's Side:**

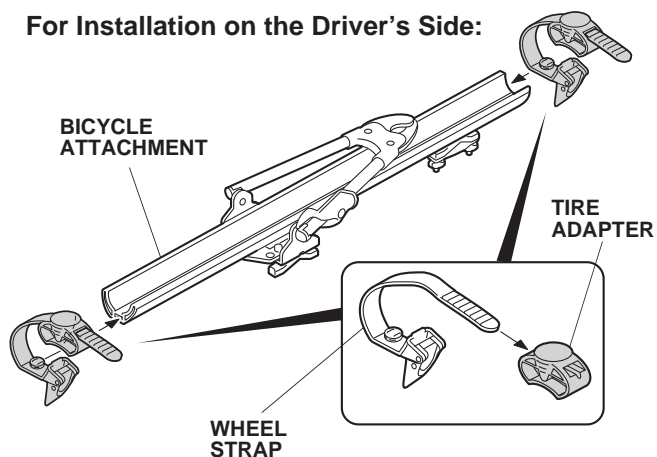

5. Install the end caps onto the bicycle attachment by aligning the lock tab on the end cap with the hole in the bicycle attachment. Push on each end cap until the lock tab “clicks” into place. Insert four bolts into the front plate.

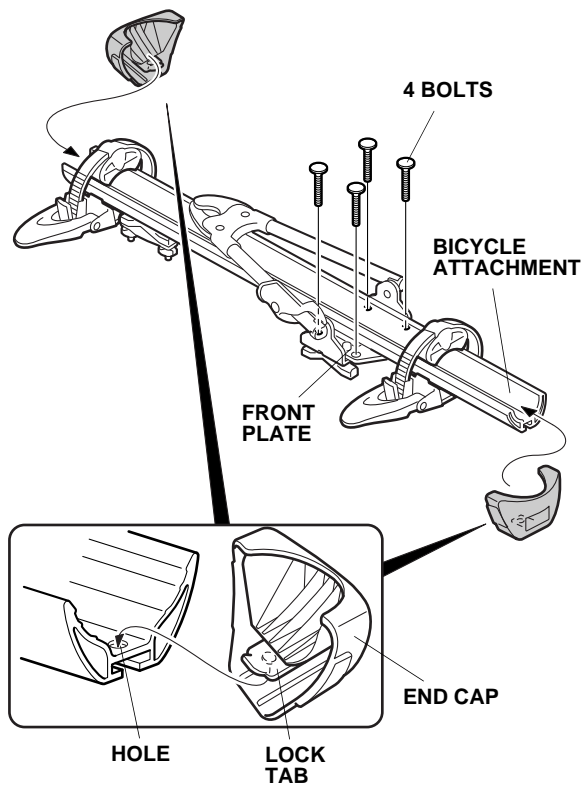

6. Install the bicycle attachment to the crossbars with six knobs, six washers, and three brackets.

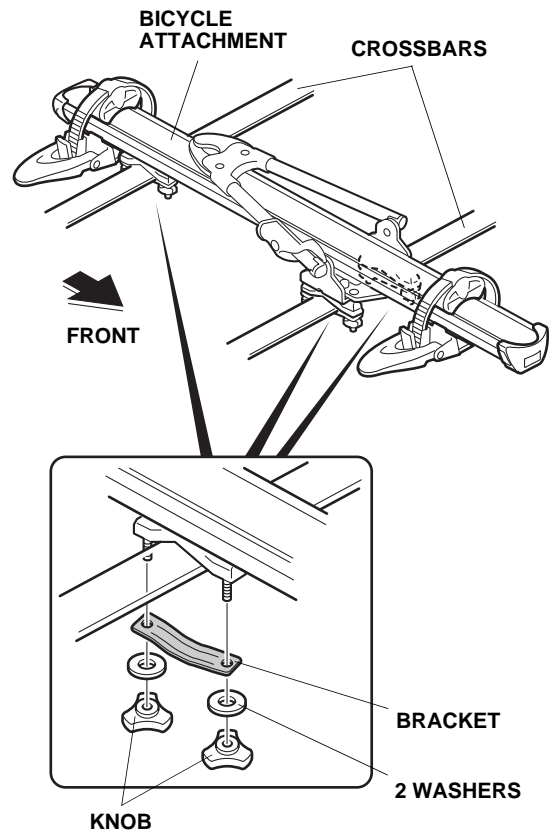

7. Close the locking clamp lever. To deter theft of the bicycle attachment, lock the locking clamp lever with the key.

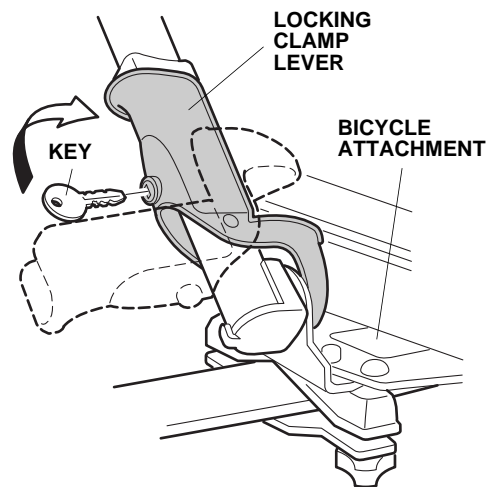

8. Write down the key number in case the key is lost or stolen.

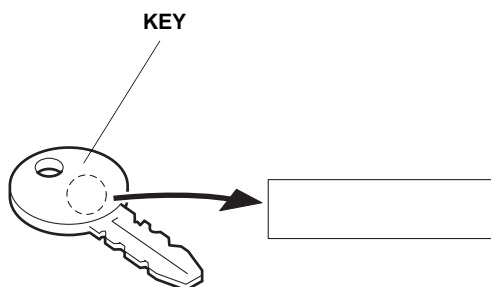

9. Store the key in the glove box for future use.

### How to Install the Bicycle on the Bicycle Attachment

10. Do not carry a bicycle with this bicycle attachment if the diameter of its frame exceeds 55 mm (2.2 in.) or if its sectional view is not circular in the area where it is held by the bicycle holder.

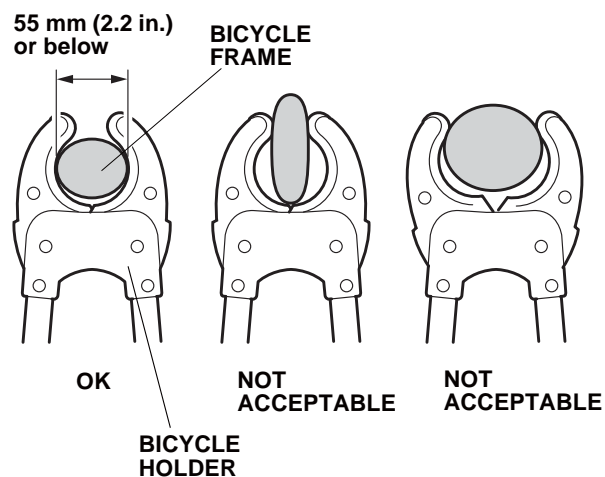

11. Release the locking clamp lever with the key and pull the locking clamp lever down.

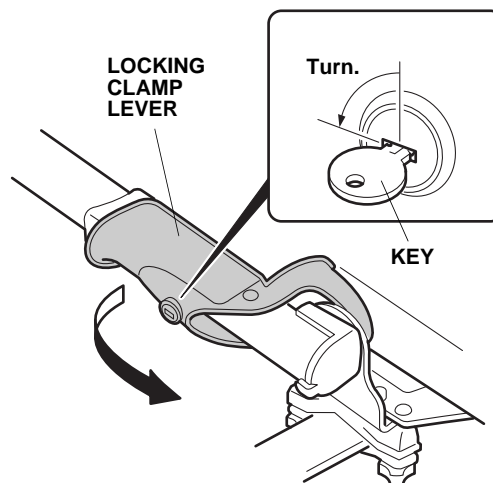

12. Position the bicycle on the bicycle attachment. Lift the arm up, position the bicycle holder around the bicycle frame, then push down the slider.

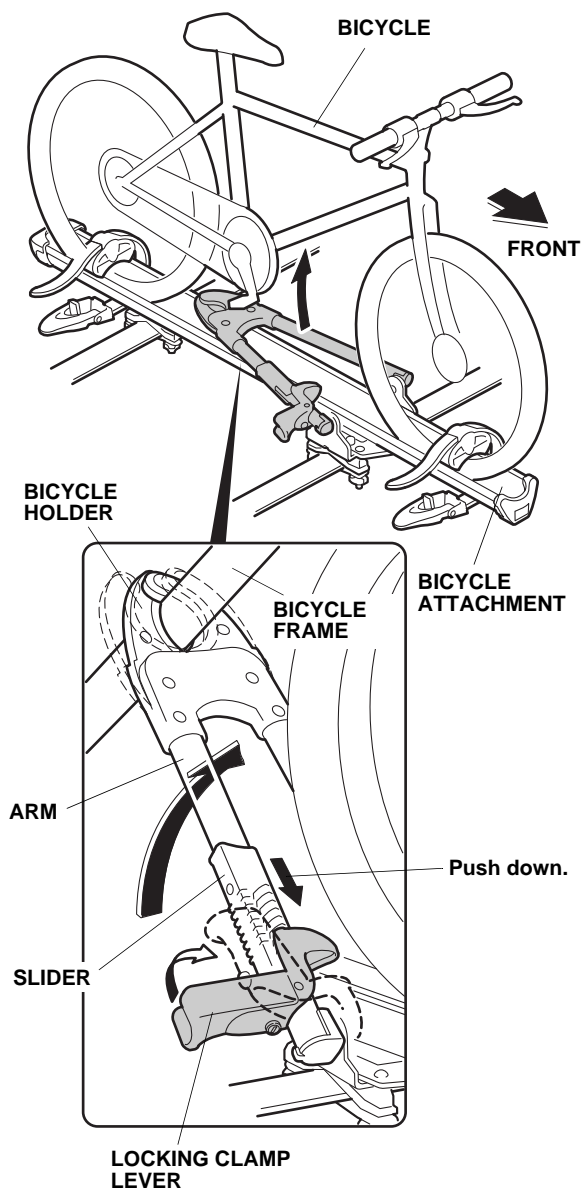

13. Push up the locking clamp lever to secure the bicycle frame.

14. Lock the locking clamp lever by inserting the key into the key cylinder and turning it in a clockwise direction.

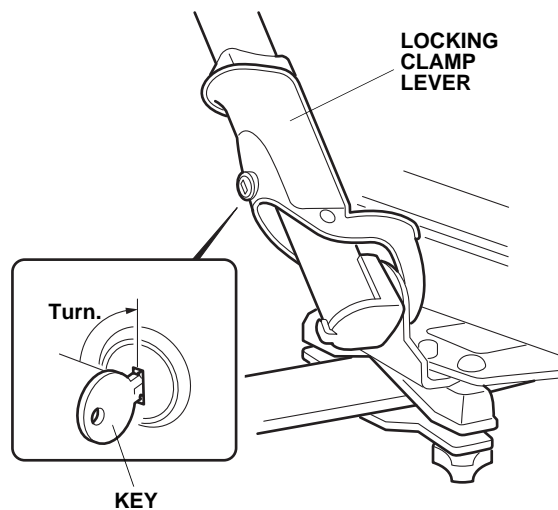

15. Position the wheel straps at the center of the bicycle wheels. Secure the wheels with the wheel straps by inserting the belts through the buckles and locking the buckles in the direction shown. If the bicycle tire is too big to be secured by the belts, reinstall the tire adapters upside down on the belts as shown. Make sure the buckles are fastened securely.

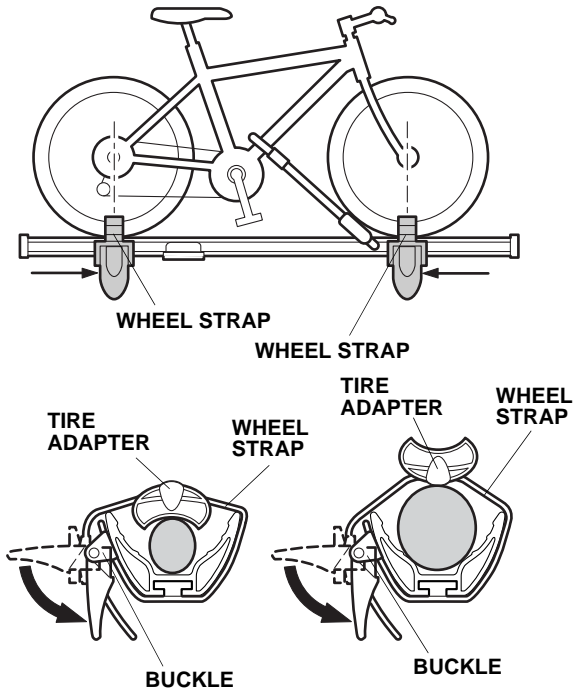

## USE AND CARE

- The addition of the bicycle attachment on the vehicle raises the overall height of the vehicle. Pay attention to overhead obstacles when driving with the bicycle attachment.
- Before and after driving, or after loading the bicycle on the attachment, check the security of the attachment mounts and retighten them as necessary.

## PRECAUTION

- Avoid sudden starts or stops with the attachment on the vehicle. It may cause bolts and other fasteners to loosen.
- Obey local laws and regulations.
- Before driving, check that the attachment is locked securely, regardless of whether a bicycle is mounted on the attachment.
- Do not use the bicycle attachment with vehicles other than those specified.